

Installation of PowerRail™ Holders

This technical bulletin is designed to assist customers in the installation of our PowerRail mat holders and hook tape. Using the materials and techniques included here will result in a safe and attractive installation.

PowerRail™ Installation Procedures

There are 2 different procedures for installing PowerRail™ holders and tape.

- 1) The “Standard Installation” requires the rails to be prepped, but results in a more attractive installation, with minimum number of visible screw heads when complete.
- 2) The “Alternate Installation” does not require the rails to be prepped, but all screw heads are visible when complete. If visible screw heads are not an issue, the alternate method can be used.

1) STANDARD INSTALLATION

Materials and Tools:

#10 Flat Head Screws *

#10 Pan Head Screws *

#10 Flat Washers

#10 Countersink Drill Bit

1/8” Drill Bit

Phillips Head Nut Driver

Variable Speed Drill

* The structure the holder is attached to will determine what type and length of screw is required. Wood, concrete, concrete block, etc., may require different types of screws, but they should be size 10 regardless of the type. Some structures may require anchors for the screws. This must be determined by the installer. 1-1/2” long screws are commonly used for installing our product.

1. Mark, drill, and countersink holes $\frac{3}{4}$ " from each end of each holder and on 12" centers along the holders' centerline. **DO NOT OVER-COUNTERSINK.** Only countersink the hole enough to hold the screw's head.

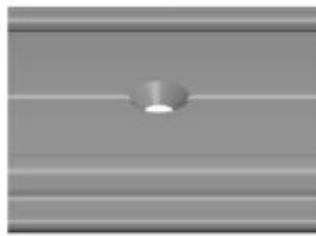
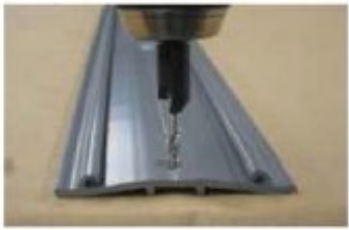

FLAT HEAD SCREW

2. Place the holders in position for installation. Mark and drill holes in the installation surface.
3. Use flat head screws in each hole. Do not over-tighten.

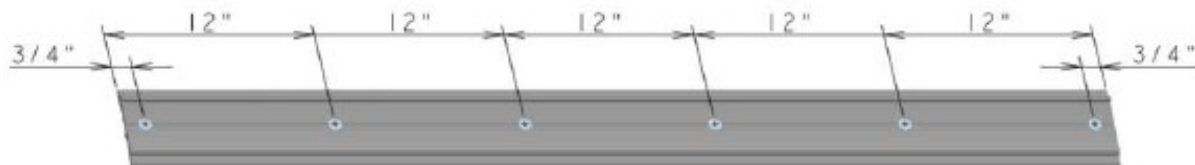

4. Insert hook tape into holders. Pulling the tape (using loop tape if available) is easier than pushing it.



5. To keep the tape from sliding in the holder, one more screw is required. Measure 3" from the end of the last holder and drill another hole through the tape, holder and the wall using the $\frac{1}{8}$ " drill bit. Do not countersink this hole.
6. Install a pan head screw with a washer in this hole. The washer is to protect the tape.

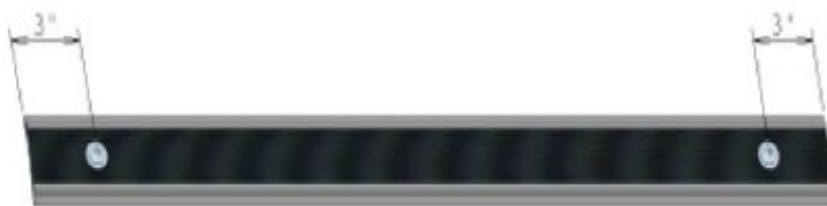

2) ALTERNATE INSTALLATION

If visible screw heads after installation are not an issue, use this method.

Materials and Tools:

#10 Pan Head Screws *

#10 Flat Washers

1/8" Drill Bit

Phillips Head Nut Driver

Variable Speed Drill

* The structure the holder is attached to will determine what type and length of screw is required. Wood, concrete, concrete block, etc., may require different types of screws, but they should be size 10 regardless of the type. Some structures may require anchors for the screws. This must be determined by the installer. 1-1/2" long screws are commonly used for installing our product.



1. Place the holders in position for installation.
2. Insert the hook tape in the holders. Pulling the tape (using loop tape if available) is easier than pushing it.
3. Drill holes through the tape, holder, and surface at 3/4" from each holder end and on 12" centers along the holder. Do not countersink the holes.



4. Install # 10 pan head screws with washers in each hole. The purpose of the washers is to protect the tape.

